



**WESTPORT**  
CONNECTICUT

Jennifer S. Tooker, First Selectwoman

January 29, 2025

Dear Community Gardener:

I hope this letter finds you well. I wanted to communicate directly with each of you to provide an update on the Community Garden. This letter confirms that the Westport Community Garden and the sports fields located on the Long Lots Elementary School Campus are closed effective December 31, 2024 to all non-school activities. I understand that some equipment remains at the garden site, and gardeners are requested to remove those possessions during the month of April, 2025. However, the real purpose of this letter is to again make the offer to relocate the Community Garden to the Baron's South property.

By way of background, in October, 2023, the feasibility study for the Long Lots School (LLS) reported that a new elementary school was needed to replace Long Lots Elementary school. As First Selectwoman, I concurred with that analysis. In that study, because a new school would be constructed concurrently with the ongoing operation of the current school, it was apparent that the entirety of the campus, including sports fields and the Community Garden area would be utilized as a construction site for at least 3 years.

With that in mind, I made a proposal for the Community Garden to be relocated to the Town-owned property at Baron's South. That central location, next to the Westport Center for Senior Activities (WCSA), is an enhanced, accessible and viable location due to the on-site infrastructure, parking, and water access. Personally, I believed this was a win-win situation, and had the proposal been accepted by the Community Garden representatives at that point, there would have been limited, if any, impact on the Spring, 2025 and future growing seasons. In my opinion, both the Town and the gardeners would benefit from this option - a new Community Garden without time constraints for its members, ADA accessible, adjacent to the WCSA and walking trails, designed in cooperation with the gardeners, a short walk to the Library and downtown shops, with water and electricity. A Community Garden that can be operational long before 2028 is the best long-term solution for current and future gardeners and for the Town of Westport.

As it currently stands, the Planning and Zoning Commission's (P&Z) 8-24 Report from January, 2024 does include a smaller version of the garden to be rebuilt on the Long Lots campus, but not at its current location, and at the conclusion of the construction of the new school. Realistically, this will not occur until 2028 at the earliest. That means no gardening will be taking place at Long Lots, in whatever final form it may take, for at least 3 growing seasons, and after that time, with no access during school hours.

I thought the time is now to reiterate the offer to build a new and fully accessible Community Garden at the Baron's South site and remove the garden from the Long Lots Campus. Certainly, there is a process that will take some time to achieve this option. This includes approvals for land

January 29, 2025  
Page 2 of 2

use and permits from P&Z and Parks & Recreation, as well as approvals for appropriations from the Board of Finance and the Representative Town Meeting (RTM).

I understand that some are concerned with the soil compatibility at Baron's South. The Town hired independent environmental scientists and soil experts who have researched and studied the soil in that area. These experts have deemed the land at Baron's South perfectly suited for a community garden.

Enclosed you will find a schematic drawing of a proposed Community Garden at Baron's South. Included in this proposal are items that were expressed as "needs" or "wants" during the multiple discussions on the relocation, most recently during 2 on-site visits in October, hosted by myself and DPW Director Peter Ratkiewich, as well as during Long Lots School Building Committee meetings. They include:

1. Clearing the area for garden plots
2. Removal of additional invasives
3. Grading along slope to flatten grade
4. 8' deer fencing and below grade animal fencing
5. Water Service
6. Electricity
7. Provide timbers and topsoil for raised beds
8. Composting Area
9. Wood chip deposit/storage area
10. Porta-john location with screening enclosure
11. Community Garden gathering area

The Town continues to express its desire to work collaboratively with the Community Garden representatives. Since early October, 2023, when the LLS feasibility report was first published, the primary goal has been to relocate the garden to a more accessible, well-functioning, efficient, expanded and enduring Community Garden to serve as a community asset in Westport. All the while, the intent was to make the transition to the Baron's South property so that gardening seasons were not lost, and that your community gardening efforts could continue and thrive. I know this is important for many of you. I also trust that most agree with that ideal and will be amenable to working together to make that happen for the betterment of our community members.

I would like to hear from each of you and encourage you to please reach out and contact me at the selectwoman's office at [selectwoman@westportct.gov](mailto:selectwoman@westportct.gov) to continue the conversation and bring the Community Garden to Baron's South.

Sincerely,



Jennifer S. Tooker  
First Selectwoman

- NOTES:
- ALL GARDEN PLOTS ARE WITHIN 100' OF A WATER SPIGOT
  - ALL GARDEN PLOTS ARE 10' x 20'
  - POLLINATOR GARDEN AREA IS APPROXIMATELY LIMITS OF CLEARING/GRADING
  - PATHS TO GARDEN PLOTS 53-140 ARE ADA COMPLIANT

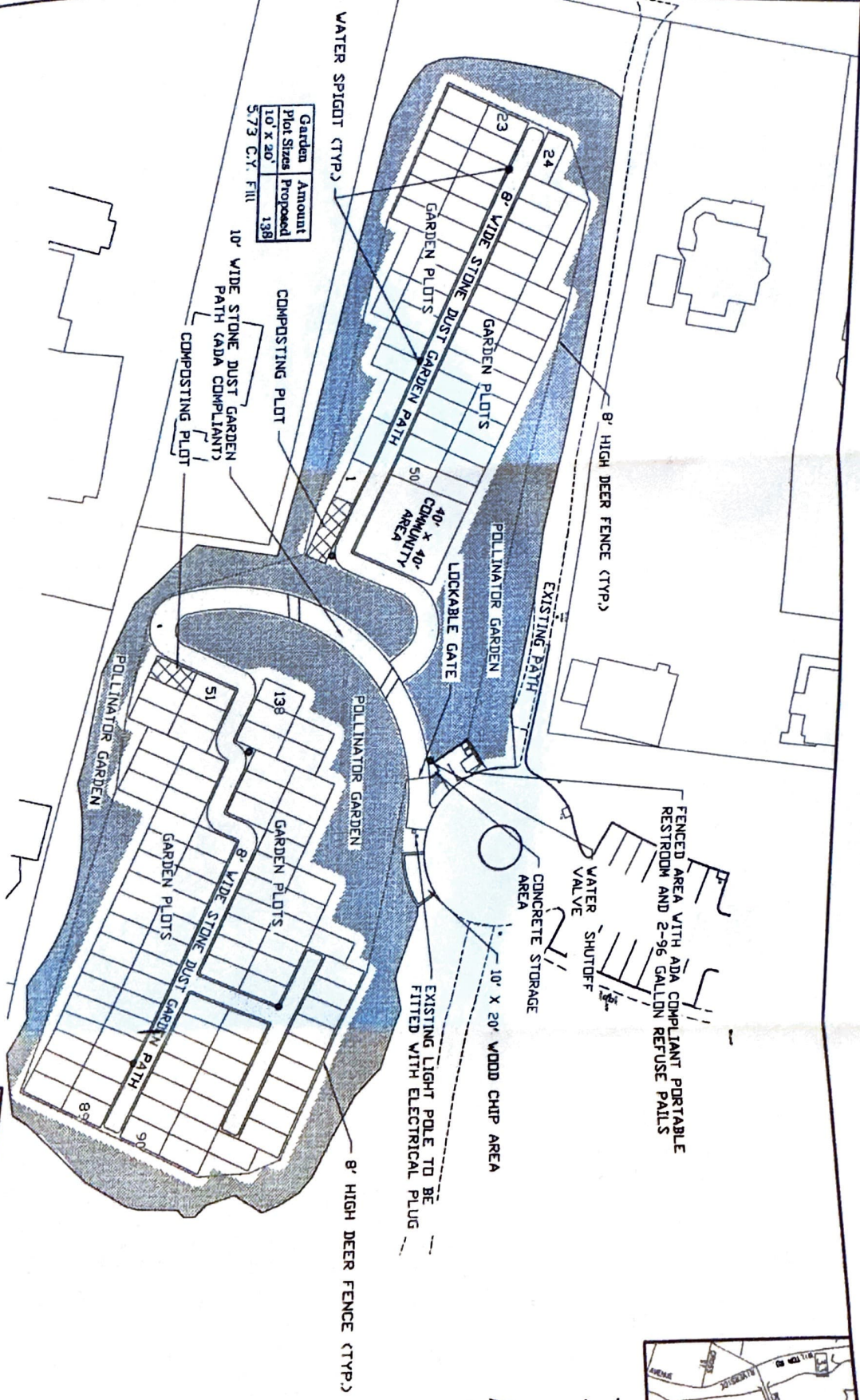

Garden Plot Sizes	Amount Proposed
10' x 20'	138
5.73 C.Y. FILL	

FENCED AREA WITH ADA COMPLIANT PORTABLE RESTROOM AND 2-96 GALLON REFUSE PAILS

CONCRETE STORAGE AREA

10' X 20' WOOD CHIP AREA

EXISTING LIGHT POLE TO BE FITTED WITH ELECTRICAL PLUG



**SITE PLAN**  
 PREPARED FOR  
**TOWN OF WESTPORT**  
 NO. 1000 ROAD SOUTH  
 WESTPORT, MAINE 04491  
 DATE: 08/20/2024

**TOWN OF WESTPORT**

DEPARTMENT OF COMMUNITY DEVELOPMENT  
 ENGINEERING DIVISION  
 1000 ROAD SOUTH  
 WESTPORT, MAINE 04491  
 TEL: 207.645.2345  
 FAX: 207.645.2346

NO.	DATE	BY	DESCRIPTION
1	08/20/2024	J. [Name]	PRELIMINARY
2	08/20/2024	J. [Name]	REVISED
3	08/20/2024	J. [Name]	REVISED
4	08/20/2024	J. [Name]	REVISED
5	08/20/2024	J. [Name]	REVISED
6	08/20/2024	J. [Name]	REVISED
7	08/20/2024	J. [Name]	REVISED
8	08/20/2024	J. [Name]	REVISED
9	08/20/2024	J. [Name]	REVISED
10	08/20/2024	J. [Name]	REVISED
11	08/20/2024	J. [Name]	REVISED
12	08/20/2024	J. [Name]	REVISED
13	08/20/2024	J. [Name]	REVISED
14	08/20/2024	J. [Name]	REVISED
15	08/20/2024	J. [Name]	REVISED
16	08/20/2024	J. [Name]	REVISED
17	08/20/2024	J. [Name]	REVISED
18	08/20/2024	J. [Name]	REVISED
19	08/20/2024	J. [Name]	REVISED
20	08/20/2024	J. [Name]	REVISED
21	08/20/2024	J. [Name]	REVISED
22	08/20/2024	J. [Name]	REVISED
23	08/20/2024	J. [Name]	REVISED
24	08/20/2024	J. [Name]	REVISED
25	08/20/2024	J. [Name]	REVISED
26	08/20/2024	J. [Name]	REVISED
27	08/20/2024	J. [Name]	REVISED
28	08/20/2024	J. [Name]	REVISED
29	08/20/2024	J. [Name]	REVISED
30	08/20/2024	J. [Name]	REVISED
31	08/20/2024	J. [Name]	REVISED
32	08/20/2024	J. [Name]	REVISED
33	08/20/2024	J. [Name]	REVISED
34	08/20/2024	J. [Name]	REVISED
35	08/20/2024	J. [Name]	REVISED
36	08/20/2024	J. [Name]	REVISED
37	08/20/2024	J. [Name]	REVISED
38	08/20/2024	J. [Name]	REVISED
39	08/20/2024	J. [Name]	REVISED
40	08/20/2024	J. [Name]	REVISED
41	08/20/2024	J. [Name]	REVISED
42	08/20/2024	J. [Name]	REVISED
43	08/20/2024	J. [Name]	REVISED
44	08/20/2024	J. [Name]	REVISED
45	08/20/2024	J. [Name]	REVISED
46	08/20/2024	J. [Name]	REVISED
47	08/20/2024	J. [Name]	REVISED
48	08/20/2024	J. [Name]	REVISED
49	08/20/2024	J. [Name]	REVISED
50	08/20/2024	J. [Name]	REVISED
51	08/20/2024	J. [Name]	REVISED
52	08/20/2024	J. [Name]	REVISED
53	08/20/2024	J. [Name]	REVISED
54	08/20/2024	J. [Name]	REVISED
55	08/20/2024	J. [Name]	REVISED
56	08/20/2024	J. [Name]	REVISED
57	08/20/2024	J. [Name]	REVISED
58	08/20/2024	J. [Name]	REVISED
59	08/20/2024	J. [Name]	REVISED
60	08/20/2024	J. [Name]	REVISED
61	08/20/2024	J. [Name]	REVISED
62	08/20/2024	J. [Name]	REVISED
63	08/20/2024	J. [Name]	REVISED
64	08/20/2024	J. [Name]	REVISED
65	08/20/2024	J. [Name]	REVISED
66	08/20/2024	J. [Name]	REVISED
67	08/20/2024	J. [Name]	REVISED
68	08/20/2024	J. [Name]	REVISED
69	08/20/2024	J. [Name]	REVISED
70	08/20/2024	J. [Name]	REVISED
71	08/20/2024	J. [Name]	REVISED
72	08/20/2024	J. [Name]	REVISED
73	08/20/2024	J. [Name]	REVISED
74	08/20/2024	J. [Name]	REVISED
75	08/20/2024	J. [Name]	REVISED
76	08/20/2024	J. [Name]	REVISED
77	08/20/2024	J. [Name]	REVISED
78	08/20/2024	J. [Name]	REVISED
79	08/20/2024	J. [Name]	REVISED
80	08/20/2024	J. [Name]	REVISED
81	08/20/2024	J. [Name]	REVISED
82	08/20/2024	J. [Name]	REVISED
83	08/20/2024	J. [Name]	REVISED
84	08/20/2024	J. [Name]	REVISED
85	08/20/2024	J. [Name]	REVISED
86	08/20/2024	J. [Name]	REVISED
87	08/20/2024	J. [Name]	REVISED
88	08/20/2024	J. [Name]	REVISED
89	08/20/2024	J. [Name]	REVISED
90	08/20/2024	J. [Name]	REVISED
91	08/20/2024	J. [Name]	REVISED
92	08/20/2024	J. [Name]	REVISED
93	08/20/2024	J. [Name]	REVISED
94	08/20/2024	J. [Name]	REVISED
95	08/20/2024	J. [Name]	REVISED
96	08/20/2024	J. [Name]	REVISED
97	08/20/2024	J. [Name]	REVISED
98	08/20/2024	J. [Name]	REVISED
99	08/20/2024	J. [Name]	REVISED
100	08/20/2024	J. [Name]	REVISED